

Not Available in New York or Rhode Island. If you are a resident of one of these states, do not proceed, please contact Wellnicity.

COLLECTION RESTRICTION

Two Weeks Before Collection Day:

- Stop taking any antibiotics, antiparasitic, antimalarial or antifungal medication.
(ONLY IF DISCONTINUATION IS APPROVED BY PHYSICIAN)
- Wait two weeks post any radiological examination involving barium sulfate to collect.

5 Days Prior to and During Sample Collection:

- Do not take or ingest the following:
 - Mineral oils
 - Non-absorbable anti-diarrheal preparations
 - Bismuth (e.g. Pepto Bismol)
 - Chewable or liquid antacids
 - Castor oil
 - Liquid petrolatum

On Collection Day:

- Do not use bulk laxatives or enemas to assist bowel movements during the period in which you are collecting your samples.
- Over-the-counter glycerin rectal suppositories may be used.



THE LIQUID PRESERVATIVES IN THE TUBES ARE TOXIC!

Do not remove liquid from tubes.

STEP 1: VERIFY TEST KIT CONTENTS

Lay out kit contents & Fill out the 'Requisition & Consent Form', filter card, and labels on collection tubes.

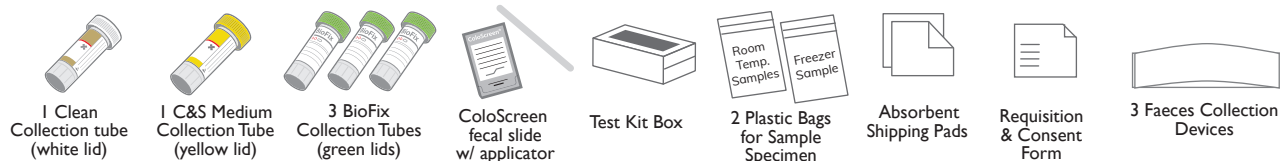

STEP 2: REGISTER YOUR TEST KIT

- ▶ Go to [Wellnicity.com](https://www.wellnicity.com) and click on **REGISTER TEST KIT** (top right hand corner of the screen)
- ▶ Register your test kit by logging into your account and **COMPLETE YOUR HEALTH PROFILE**.

STEP 3: SAMPLE COLLECTION

Use Faeces Collection Device to collect sample. Follow instructions stated on the collection device.

Collection Schedule

Day 1

Collect your samples in the Clean tube (white lid) and one BioFix tube (green lid.)

- Follow the Collection Procedure
- **Freeze the Clean tube (white lid) as soon as possible.** Keep frozen until you are ready for return shipping.
- Store BioFix tube (green lid) at room temperature.

Day 2

Collect your samples in one BioFix tube (green lid) and the C&S tube (yellow lid).

- Follow the Collection Procedure and store samples at room temperature.

Day 3

Collect your samples in the last BioFix tube (green lid).

- Follow the Collection Procedure and store samples at room temperature with Day 2 samples.

Prepare the ColoScreen card:

- Open the flap of the card and follow the instructions located inside. Use wooden applicator for this step of the procedure.

Collection Procedure

1. Write your **name**, the **date of collection** and your **birth date** on the collection tube label. No other information is required on the label.
2. **Collect a sample.** Carefully open the collection tube. Using the spoon built into the lid of the tube, place small scoops of stool from areas which appear bloody, slimy or watery, into the tube **until all contents reach the red line.** (Fig. 1&2)
3. Close the tube. Twist the lid until it is firmly closed. **Do not overtighten the lid and do not remove spoon.**
4. Vigorously shake the closed collection tube until the contents and the liquid are well mixed. You do not need to shake the Clean tube (white lid). (Fig.3)
5. Wash your hands with soap and water.
6. Place the closed collection tube into a biohazard bag with the absorbent white pad.

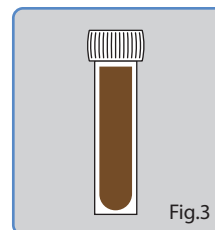
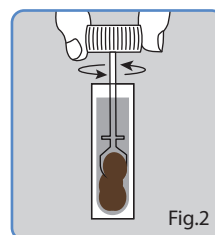
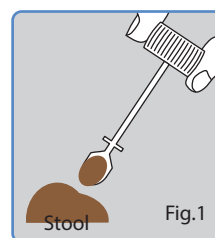

SAMPLES MUST BE SHIPPED WITHIN 24 HOURS OF COLLECTION. See reverse side for shipping instructions.

STEP 4: SHIPPING INSTRUCTIONS

RETURNING YOUR SAMPLE

- ▶ Make sure your 'Requisition & Consent Form' is completed and you have registered your test kit online.
- ▶ Place the 'Requisition & Consent Form' inside the slot on the outside of the plastic bag for sample specimen.
- ▶ Place the samples inside the plastic bag with absorbent pad; place in test kit box to return and seal.
- ▶ Place the test kit box containing sample inside the pre-labeled FedEx return bag (included at the bottom of your test kit package).
- ▶ Once sealed, record or take a picture of the shipping label located on your FedEx return bag to track your sample journey.
- ▶ Deliver sealed sample return bag to a FedEx shipping location. Transit to the laboratory takes approximately 2 business days.



Ship your samples within 24 hours and ONLY ON MON THROUGH WED. Do not ship samples Thurs through Sun.

NEXT STEPS

- ▶ Upon receipt, the lab will begin processing your sample. A completed 'Requisition & Consent Form' is required and must accompany your sample.
- ▶ Your results will be reviewed by a Wellnicity clinician and securely transmitted to your online account.
- ▶ You will receive an email when your test results are ready, approximately 5-7 business days following the receipt of your sample.